

SYDNEY COVE

PROPERTY



314/27 Park Street Sydney NSW

1 1 1

SOLD BY BRYN FOWLER 0423 663 663

Perched high on level 31 on the preferred North East corner of Landmark Park Regis, and providing some of the best views in Sydney - this is a most rare opportunity!

View : <https://www.sydneycoveproperty.com/sale/nsw/sydney-city/sydney/residential/apartment/6214434>

Amazing iconic views over Hyde Park to Sydney Harbour and the heads are enjoyed from the moment you enter the apartment.

Park Regis is the first residential tower in the CBD; apartments here are as popular as they are rare as they have been tightly held by owners who love the fantastic mid-city location, amazing views and a well-run building with a very proactive Building Manager on site.



Bryn Fowler
02 8259 3333

An ideal city pad, weekender or investment choice, this furnished pet friendly apartment offers;

<https://www.sydneycoveproperty.com>

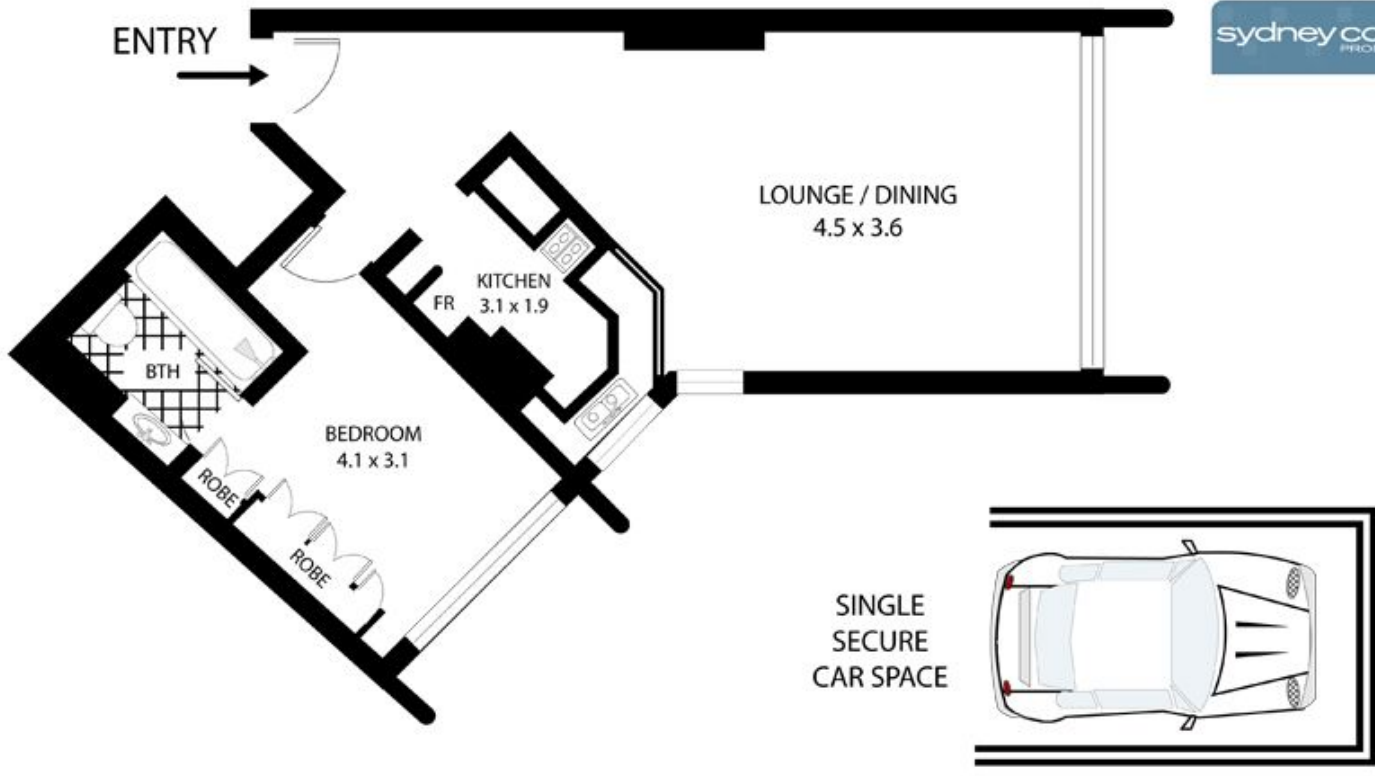

314/27 Park St Sydney

All measurements are approximate only. Plan is provided as an indication of layout



SCALE