

SYDNEY COVE

PROPERTY



1520/18 Park Lane Chippendale NSW

1 1

SOLD BY BRYN FOWLER 0423 663 663

Enjoy an envious inner city lifestyle within Central Park: the innovative and award winning complex designed by world renowned JPW Architects. The Mark has been called the future of vibrant inner city living offering the life of absolute convenience with virtually everything you could need within just a short walk from your door.

Key points:

- * 50m2 city fringe apartment or quality investment
- * Enclosed loggia with open North Westerly views
- * Light and airy interiors, ducted air-conditioning
- * Smart gas kitchen inc dishwasher & refrigerator
- * Well-proportioned bedroom, built-in wardrobes
- * Chic bathroom, internal laundry inc washer/dryer
- * Common rooftop terrace, pool, spa & BBQ area

View : <https://www.sydneycoveproperty.com/sale/nsw/sydney-city/chippendale/residential/apartment/6214673>



Bryn Fowler
02 8259 3333

<https://www.sydneycoveproperty.com>

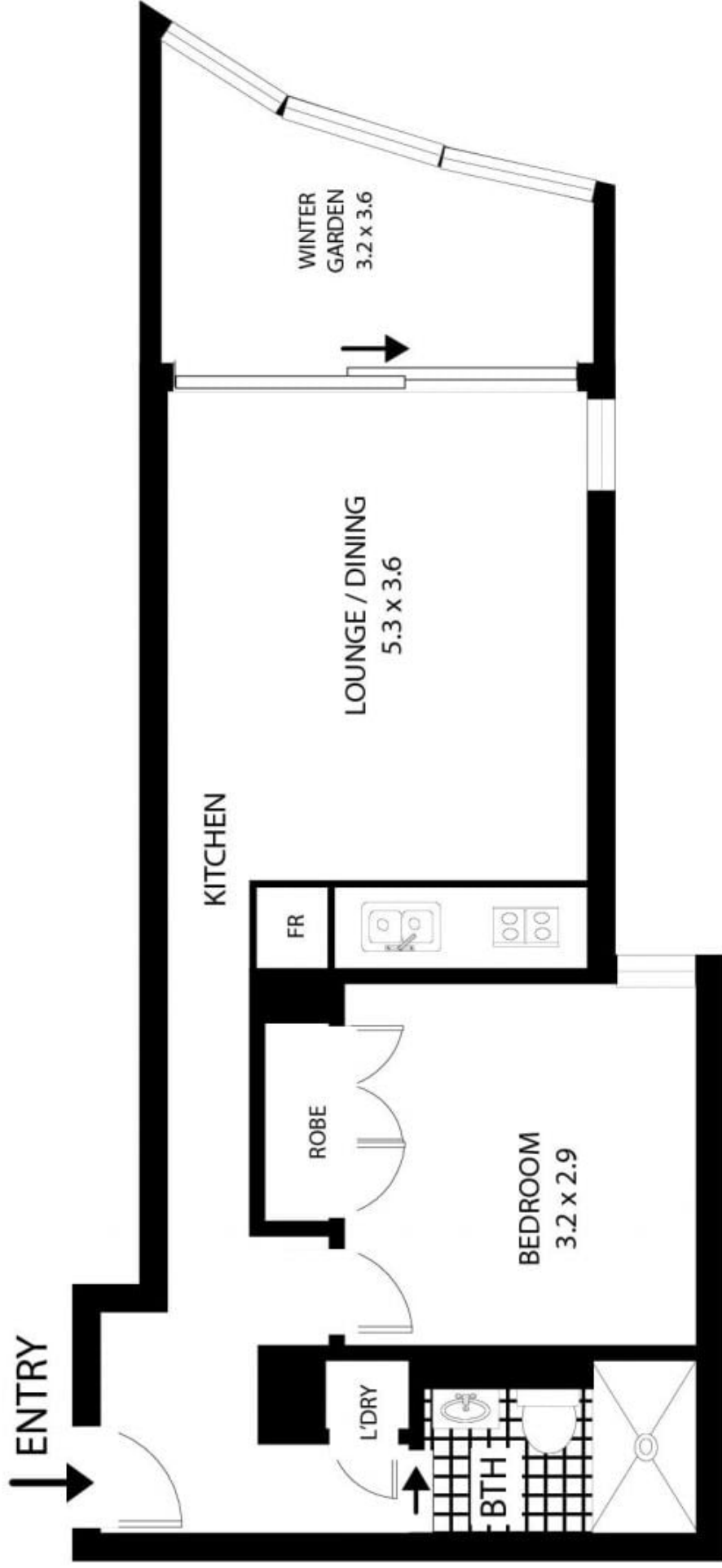

NOTE: EXT STORAGE ON TITLE (approx 25QM)



SCALE

1520/18 Park Ln Chippendale

All measurements are approximate only. Plan is provided as an indication of layout