

SYDNEY COVE

PROPERTY



281 Elizabeth Street Sydney NSW

2 2 1

SOLD PRIOR AUCTION - BRYN FOWLER 0423 663 663

Well-presented two bedroom apartment in the coveted and tightly-held Regency Hyde Park, offering a fabulous lifestyle in such an amazing city location. All the city's delights within a short walk from your door, cafes, bars, theatres, museums and restaurants, this apartment is sure to impress. Buses at your door and Museum Train Station across the Street.

Price : \$ 950,000

View : <https://www.sydneycoveproperty.com/sale/nsw/sydney-city/sydney/residential/apartment/6214777>

- * Spacious well-proportioned interiors
- * Practical floorplan for ease of living
- * Two double bedrooms with built-ins
- * Gas kitchen with granite benchtops
- * Two bathrooms, ensuite with bath
- * Secure car space right opposite lift
- * 24h concierge, gym, pool, spa, sauna



Bryn Fowler
02 8259 3333

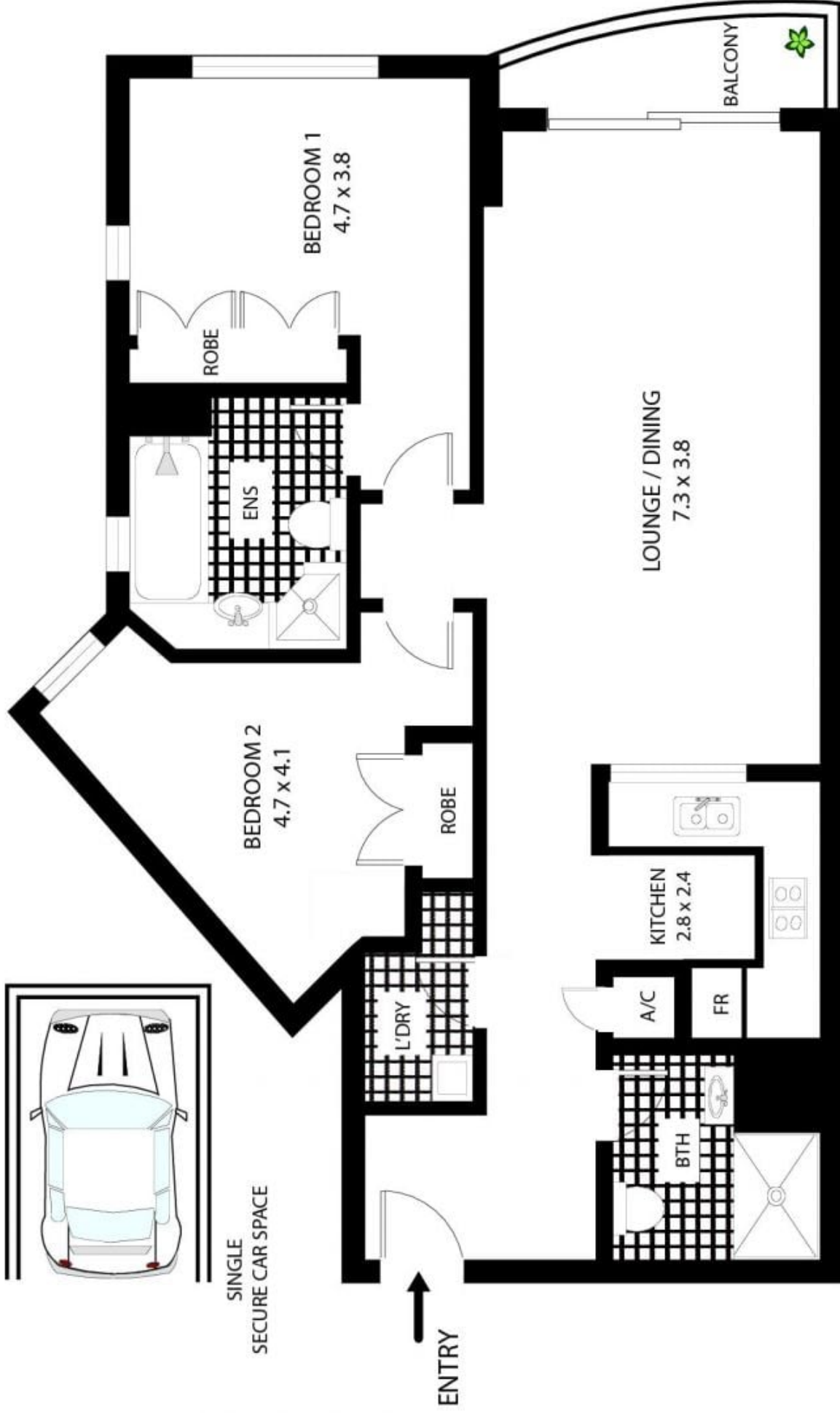

805/281 Elizabeth St Sydney

All measurements are approximate only. Plan is provided as an indication of layout