

# SYDNEY COVE

PROPERTY



241/420 Pitt Street SYDNEY NSW

2 2 1

Beautifully renovated apartment with high views overlooking the surrounding greenery and the iconic 100-year-old Central Station Clock Tower. The Mosaic building is the perfect fit for anyone wanting to live the enviable city lifestyle or purchase a solid investment. Only 200m away from World Square and a short stroll away from Central Station and Capital Theatre and the light rail, with easy access up and down George Street. The apartment features fantastic additional custom-made storage and cabinetry throughout.

- Spacious living area, bright urban outlook
- Large gas kitchen, dishwasher, ample storage
- Two large bedrooms with built-in wardrobes
- Split level apartment ready to move in to enjoy
- Featuring stunning floorboards, study area
- Secure building, gym, concierge and intercom

**Price** : \$ 1,170,000

**View** : <https://www.sydneycoveproperty.com/sale/nsw/sydney-city/sydney/residential/apartment/6700304>



**Bryn Fowler**  
02 8259 3333



**Monique Lavers**  
82593333

<https://www.sydneycoveproperty.com>

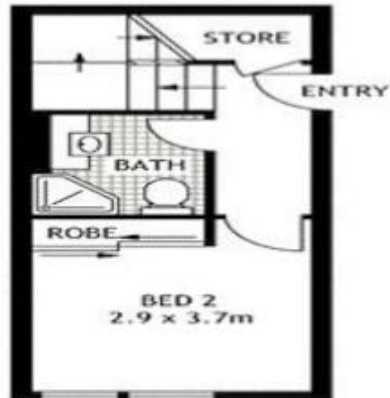

TWENTY FOURTH FLOOR



TWENTY FIFTH FLOOR



241/420 PITT STREET

SCAPE Floor Planning Disclaimer: This floor plan is conceptual only. It is provided for illustrative purposes only and should not be relied upon. We make no guarantees to the correctness of this plan. All interested parties should make and rely on their own enquiries in determining the accuracy of the information contained in this floor plan.