

# SYDNEY COVE

PROPERTY



**1203/653 George Street Sydney NSW**



Presenting a fantastic opportunity to own an incredible apartment located in the premier Mantra Sydney Central building, perfect for SMSF or investors looking to earn great returns. Positioned for walk-to-everything convenience with World Square shopping complex only a 160m stroll away and easy access to Belmore Park.

**Price** : \$ 449,500

**View** : <https://www.sydneycoveproperty.com/sale/nsw/sydney-city/sydney/residential/studio/7672002>

- Estimated net returns of \$44,169.76 - \$56,371.76 p/a with short term leasing
- Great flexibility to short term let or lease through Mantra - your choice!
- Take advantage of the rapidly improving accommodation market
- Well appointed, contemporary interiors featuring low strata levies
- Centrally located building, with 24hr reception and on-site restaurant



**Brenden Taliana**  
02 9241 1288



**Bryn Fowler**  
02 8259 3333

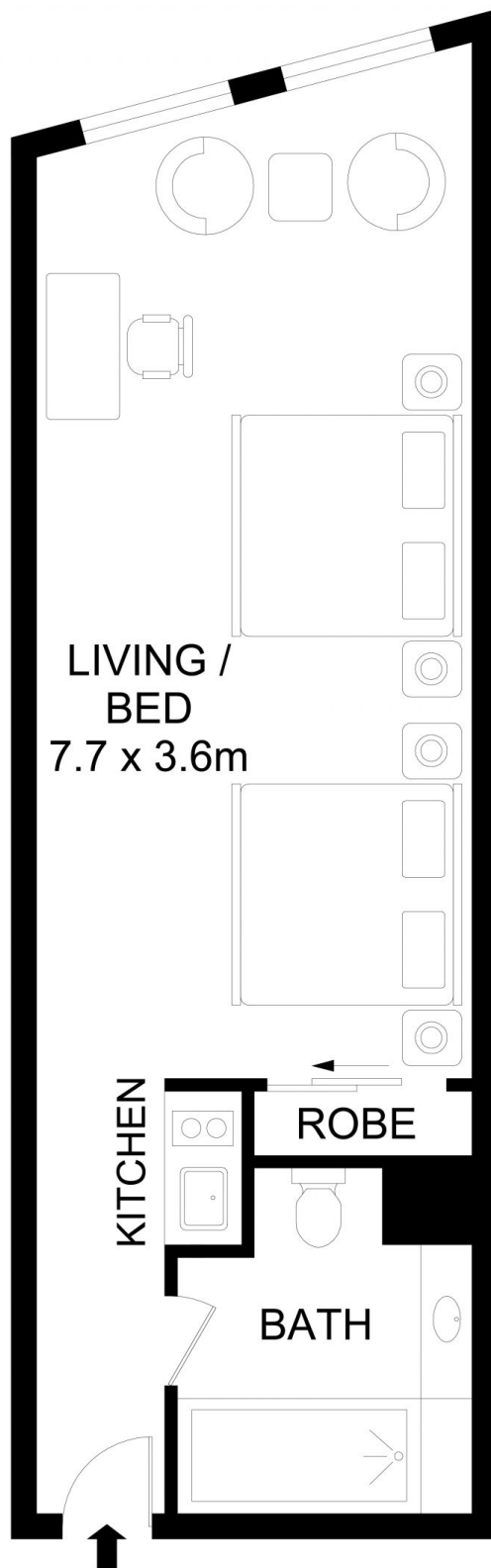

LIVING /  
BED  
7.7 x 3.6m

KITCHEN

ROBE

BATH



### Unit 1203/653 George street, Haymarket

Disclaimer- Floor Plan measurements are approximate and are for illustrative purposes only. While we cannot doubt the floor plans accuracy , we make no guarantee , warranty or representation as to the accuracy and completeness of the floor plan