

# SYDNEY COVE

PROPERTY



## 1207/653 George Street Sydney NSW

1 

Presenting a fantastic opportunity to own an incredible apartment located in the premier Mantra Sydney Central building, perfect for SMSF or investors looking to earn great returns. Positioned for walk-to-everything convenience with World Square shopping complex only a 160m stroll away and easy access to Belmore Park.

**Price** : \$ 445,000

**View** : <https://www.sydneycoveproperty.com/sale/nsw/sydney-city/sydney/residential/studio/7726383>

- Estimated net returns of \$44,945.68 - \$57,147.68 p/a with short term leasing
- Great flexibility to short term let or lease through Mantra - your choice!
- Take advantage of the rapidly improving accommodation market
- Well appointed, contemporary interiors featuring western city views
- Sofa bed included, ducted air conditioning, well equipped kitchenette



**Brenden Taliana**  
02 9241 1288



**Bryn Fowler**  
02 8259 3333

<https://www.sydneycoveproperty.com>

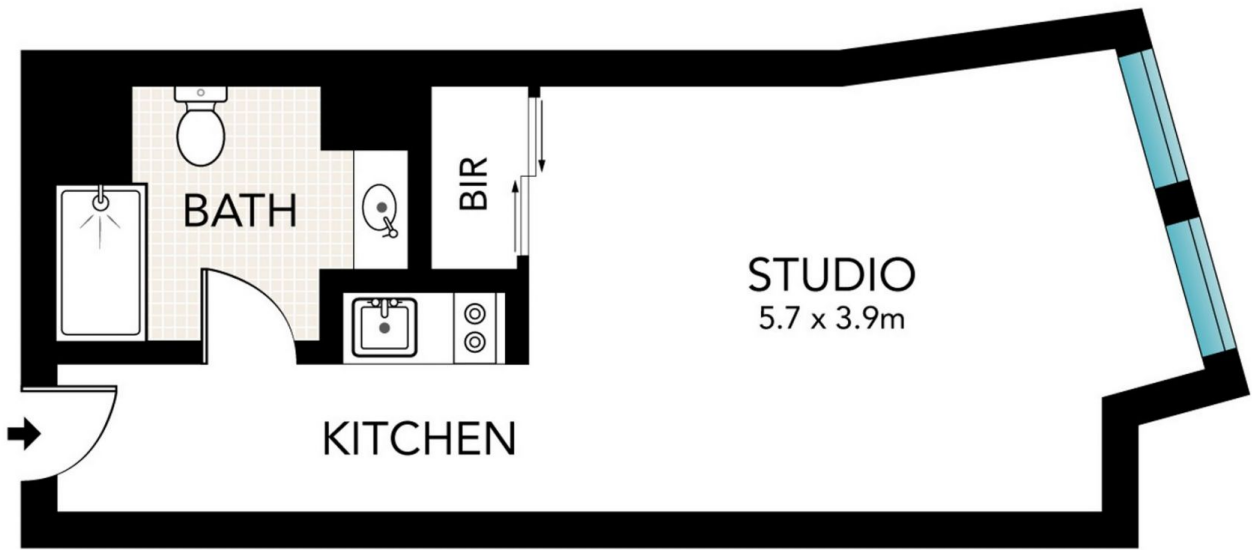

Scale in metres. Indicative only. Dimensions are approximate. All information contained here in is gathered from sources we believe to be reliable. However, we cannot guarantee its accuracy and interested persons should rely on their own enquiries.



1207/653 George Street, Haymarket

**SYDNEY  
COVE**  
PROPERTY