

SYDNEY COVE

PROPERTY

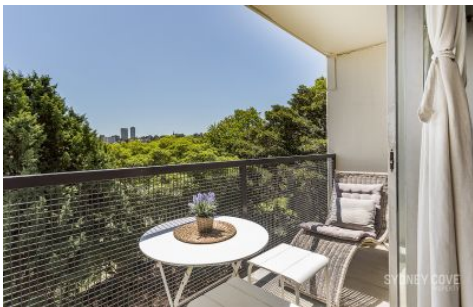

50 Roslyn Gardens RUSHCUTTERS BAY NSW

1 1 1

An intelligently planned high-modernist apartment from architect Harry Seidler's most productive Sydney period, the Aquarius building is a well-kept secret amongst architects and designers. The building embodied a 1970s vision of the perfect lifestyle for the urban professional. Now surrounded by its well established garden, Aquarius offers both privacy and cosmopolitanism, with urban views and a pool for residents.

The apartment has a highly functional floor-plan, with a frankfurt style galley kitchen. The bedroom, on its own level, is designed with free-standing walls for improved sound isolation, and windows on both sides of the apartment allow for excellent cross ventilation. Parking is shared.

Owners are looking for long term tenant with an interest in

View : <https://www.sydneycoveproperty.com/lease/nsw/eastern-suburbs/rushcutters-bay/residential/apartment/7841989>



Gareth Bootland
02 8259 3333

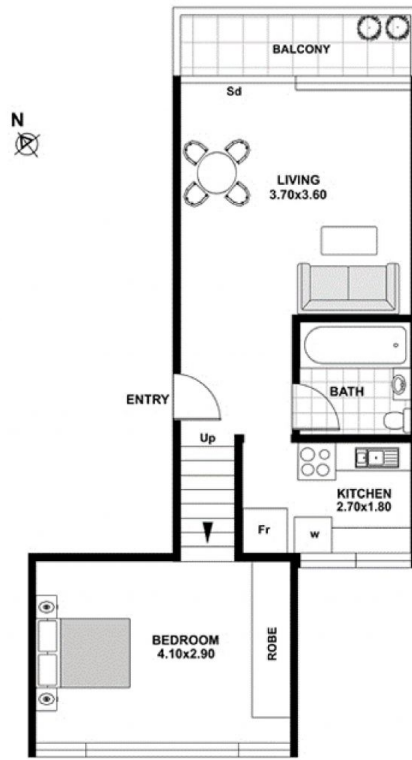

SYDNEY COVE
PROPERTY

42/50 Roslyn Gardens, Rushcutters Bay

All measurements are approximate only. Plan is provided as an indication of layout.