

SYDNEY COVE

PROPERTY



2 Bond Street Sydney NSW

1 1

Perfectly positioned in the heart of Sydney CBD, this studio apartment is only moments from Wynyard train station, Circular Quay, Martin Place. Surrounded by shopping, restaurants and night spots with the convenience of hotel facilities including roof top pool, gym & hotel cafe/bar.

View : <https://www.sydneycoveproperty.com/lease/nsw/sydney-city/sydney/residential/apartment/8016935>

Key Points

- * Impressive layout, fully furnished apartment
- * Kitchen with stone & quality appliances
- * Modern stone bathrooms, built in robe
- * Air-con, internal laundry, video intercom
- * Access to hotel amenities incl. concierge
- * Impressive roof top pool, spa and gym



Gareth Bootland
02 8259 3333

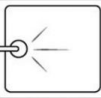
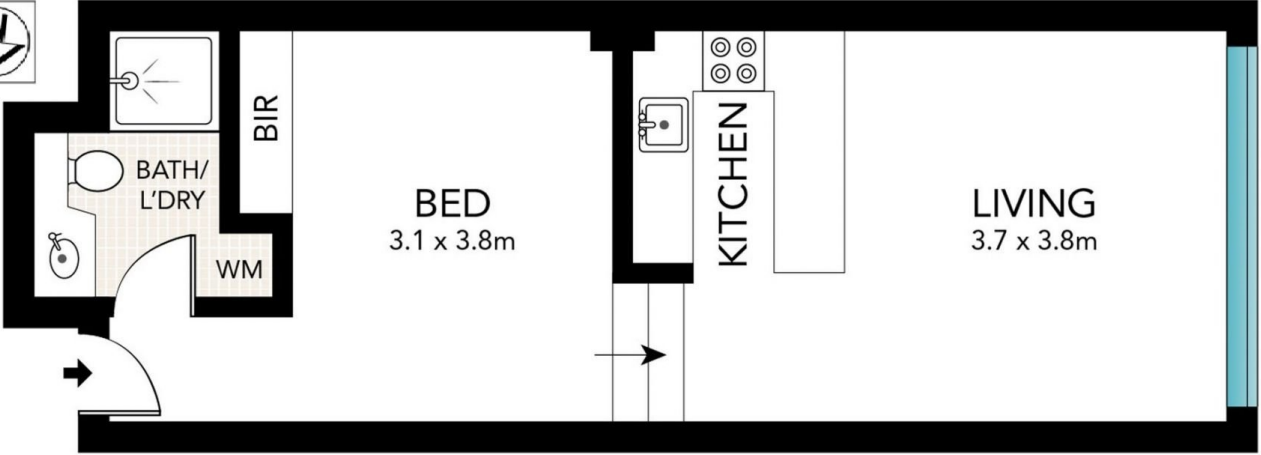

BATH/
L'DRY

BIR

WM

BED
3.1 x 3.8m



KITCHEN



LIVING
3.7 x 3.8m