

SYDNEY COVE

PROPERTY



21/359 Pitt Street Sydney NSW

1 

Well-designed studio apartment situated in the exclusive 'The Regent' building. This exceptional apartment makes an ideal city pad or a great investment property for astute investors looking for a easy to rent, great returning apartment. Located in the heart of the Sydney CBD, just a short walk from Town Hall Station, the QVB, and World Square.

Price : Contact Agent

View : <https://www.sydneycoveproperty.com/sale/nsw/sydney-city/sydney/residential/studio/8029165>

- Spacious open-plan layout featuring a built-in wardrobe
- Full sized tiled bathroom including a bathtub
- Well proportioned kitchen, good storage throughout
- Large balcony with eastern city views, floor to ceiling windows
- Building includes lift access and secure intercom system
- Close proximity to Town Hall and World Square shopping centre
- Strata: \$1,492.47 p/q, Council: \$308.65 p/q, Water:



Brenden Taliana
02 9241 1288



Bryn Fowler
02 8259 3333

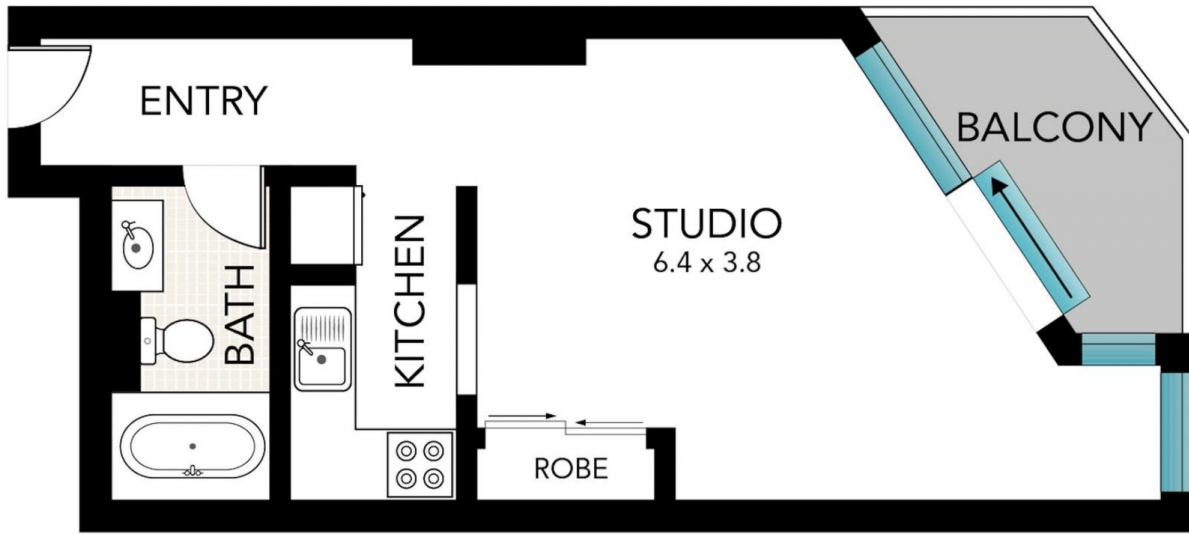

Scale in metres. Indicative only. Dimensions are approximate. All information contained here in is gathered from sources we believe to be reliable. However, we cannot guarantee its accuracy and interested persons should rely on their own enquiries.

21/359 Pitt Street, Sydney

**SYDNEY
COVE**
PROPERTY