

# SYDNEY COVE

## PROPERTY



115/222 Sussex Street Sydney NSW

1 1

Enjoy the energy and excitement of a busy CBD lifestyle from the apartment perfectly positioned in the executive building 'Astoria Tower'. This apartment offers a unique city layout, enjoy absolute convenience with its location just moments to Darling Harbour & Town Hall station.

- The only one-bedroom apartment in Astoria Tower
- Conveniently positioned on the west side of level 2
- Spacious, well-proportioned interiors throughout
- Large, enclosed sunroom/2nd living area, study, office
- Internal laundry, ducted A/C and intercom entry
- Concierge, pool, gym, games room & squash court
- Easy access, large storage room right next to unit
- Strata: \$1,508.93 p/q, Council: \$322.20 p/q, Water: \$179.90 p/q - approx

**Price** : \$965,000

**View** : <https://www.sydneycoveproperty.com/sale/nsw/sydney-city/sydney/residential/apartment/8080389>



**Bryn Fowler**  
02 8259 3333



**Grant Ashby**  
02 9241 1288

\*Images featuring virtual furnishings

<https://www.sydneycoveproperty.com>

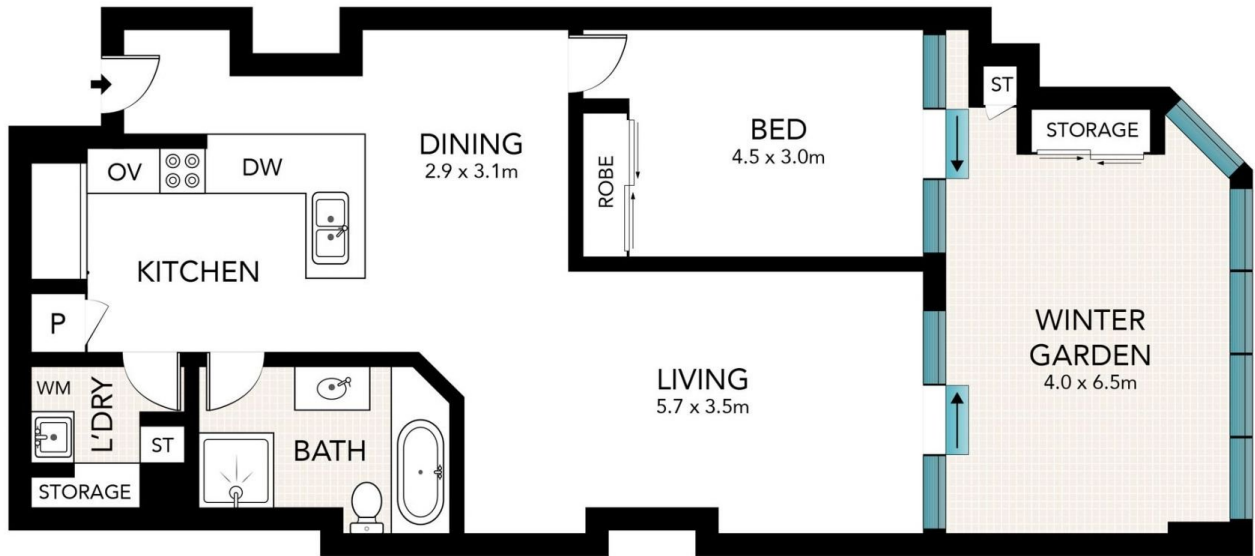

0 1 2 3 4 5



Scale in metres. Indicative only. Dimensions are approximate. All information contained here in is gathered from sources we believe to be reliable. However, we cannot guarantee its accuracy and interested persons should rely on their own enquiries.

115/222 Sussex Street, Sydney

**SYDNEY  
COVE**  
PROPERTY